

# Layout #33 - February 2021

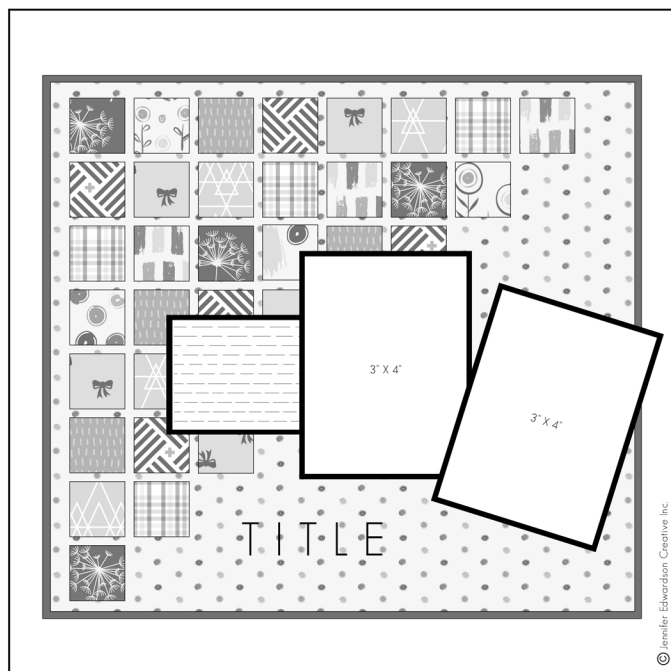

## Supplies Required:

- (1) 12x12" CS base
- (1) 12x12" CS for large mat
- (1) 12x12" CS for photo mats
- (1) 12x12 PP
- (6-8) different PP ... you will create 1" squares out of these pcs.
- PHOTOS: (2) 3x4"
- I used a journal card from our Printables on this layout!
- Alphas and Embellishments

## Instructions:

- 12 x 12" CS base
- Cut (1) CS to  $9\frac{3}{4}$  V x  $10\frac{3}{4}$  H; Adhere centered on base
- Cut (1) PP to  $9\frac{1}{2}$  V x  $10\frac{1}{2}$  H; Adhere on top of CS mat
- Using 6-8 different PP cut (36) 1 x 1" squares
- Starting in the top left corner as shown, lay out your tiny squares in a pattern that you love and adhere
- Cut (2) photo mats  $\frac{1}{4}$ " larger than the size of your photos
- PHOTOS: I used (2) 3 x 4" V matted on  $3\frac{1}{4}$  x  $4\frac{1}{4}$  mats
- Add journaling card if desired
- Title and Embellish

NOTES: \_\_\_\_\_

\_\_\_\_\_  
\_\_\_\_\_  
\_\_\_\_\_