

# Layout #7 - May 2020

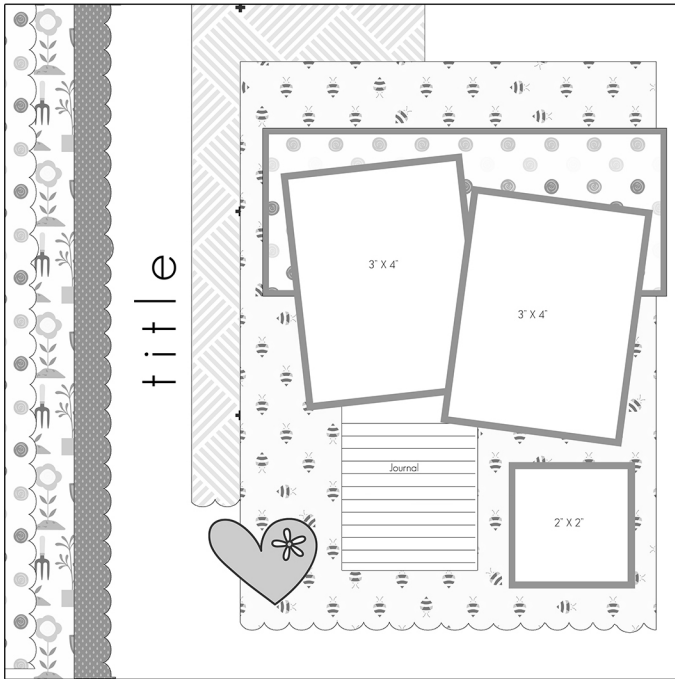

## Supplies Required:

- (1) 12x12" CS for base
- (1) 12x12" CS for photo mats
- (1) 12x12" CS for a PP mat
- (3) 12x12" PP
- (3) min. 1x12" PP strips (washi tape or border stickers could be used here as well)
- PHOTOS: (2) 3x4" (1) 2x2"
- Alphas and Embellishment

NOTES: \_\_\_\_\_

\_\_\_\_\_

\_\_\_\_\_

\_\_\_\_\_

\_\_\_\_\_

\_\_\_\_\_

\_\_\_\_\_

\_\_\_\_\_

## Instructions:

- 12 x 12" CS base
- Cut (1) PP strip to 1 x 12"; Adhere at left edge of base
- Cut (1) PP strip to  $\frac{1}{2}$  x 12"; Adhere raised on top of 1st strip at edge of base
- Border punch (1) PP strip down to  $\frac{1}{2}$  x 12"
- Adhere this at right edge of 1st PP as shown
- Cut (1) PP to  $3\frac{1}{2}$  x 9" (black plaid); Border punch bottom edge and adhere  $1\frac{1}{4}$ " in from edge of strips as shown
- Cut (1) PP to  $8\frac{1}{2}$  x  $10\frac{1}{2}$ "; Border punch bottom edge and adhere 1" down from top and  $\frac{1}{2}$ " in from right edge of base
- Cut (1) PP to  $4\frac{1}{4}$  x 8" and mat onto  $4\frac{1}{2}$  x  $8\frac{1}{4}$ " CS; Adhere raised 2" down from top and  $\frac{1}{4}$ " in from right edge of base
- Double mat (2) 3 x 4" and (1) 2 x 2" photos; Adhere as shown
- Title and Embellish as desired

