

Layout #17 - September 2020

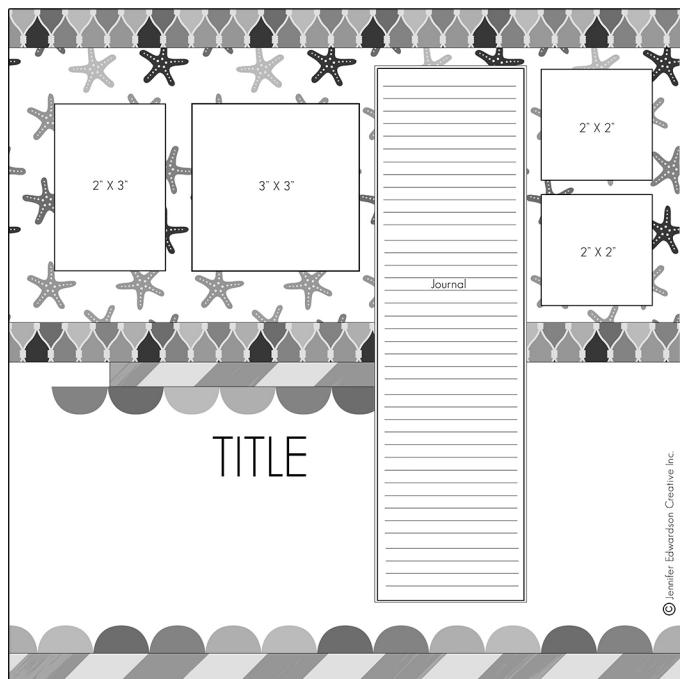

Supplies Required:

- (1) 12x12" CS
- (1) 12x12" PP
- (6) min. 2x12" PP strips, washi tape, stickers or a mix of all
- Optional: 12x12" CS for photo mats
- I used our long BASICS journal card on this page. You can download and print it from my website www.shopjenniferedwardson.com
- PHOTOS: (2) 2x2" (1) 3x3" (1) 2x3"
- Alphas and Embellishments

NOTES: _____

Instructions:

- 12 x 12" CS base
- Cut (1) PP to 5 1/2 x 12"; Adhere 3/4" down from top
- Cut (2) 1 x 12" PP strips from same paper
- Adhere one raised at top of base and the other flat at bottom of 1st PP as shown
- Adhere 3 x 9" journal card (from our BASICS printable) 2 3/4" in from right edge of base
- Cut (1) PP strip (orange) to 1/2 x 5"; Adhere at left edge of journal card as shown
- Cut (1) PP strip to 3/4 x 6", border punch and adhere under last piece as shown (green)
- Cut (1) PP strip to 1/2 x 12"; Adhere at bottom of base
- Cut (1) PP strip to 3/4 x 12", border punch and adhere slightly overlapping top of last PP strip as shown
- PHOTOS: using CS, mat (1) 2 x 3" and (1) 3 x 3" photo (optional) and adhere to left of journal card. Adhere (2) 2 x 2" photos to right of journal card as shown
- Title and Embellish as desired